

For Commercial and Industrial Applications

Job Name _____
 Job Location _____
 Engineer _____
 Approval _____

Contractor _____
 Approval _____
 Contractor's P.O. No. _____
 Representative _____

LEAD FREE*

Series LFB6800, LFB6801 3-Piece, Full Port, Lead Free* Ball Valves

Sizes: 1/4" – 2"

Series LFB6800, LFB6801 3-Piece, Full Port, Lead Free* Ball Valves feature an in-line maintenance design that offers serviceability of all operating parts without disturbing the rigid pipeline system. The LFB6800, LFB6801's full port orifice ensures maximum flow capacity, while Durafill® seats, stainless steel ball and stem provide maximum safety and highest operating pressure and temperature limits. The LFB6800, LFB6801 features Lead Free* construction to comply with Lead Free* installation requirements.

Features

- Lead Free* copper silicon alloy body
- 3-piece, lift-out design
- Carbon/glass reinforced PTFE Durafill® valve seats
- Stainless steel ball and stem
- Blow-out proof, pressure retaining stem
- Standard actuator mounting pads
- Vinyl insulator on heavy duty, zinc plated carbon steel handles
- Low operating torque
- Adjustable stem packing gland
- Each valve factory tested

Models

LFB6800 1/4" – 2" threaded NPT end connections

LFB6801 1/2" – 2" solder end connections**

*The wetted surface of this product contacted by consumable water contains less than 0.25% of lead by weight.

**This valve is designed to be soft soldered into lines without disassembly, using a low temperature solder (420°F/216°C). Other solders such as 95/5 tin antimony (460°F/238°C) can be used. However, extreme caution must be used to prevent seat damage. Higher temperature solders will damage the seat material. ANSI B.16.18 states that the maximum operating pressure of 50-50 solder connections is 200psi (14 bar) at 100°F (38°C) and decreases with higher temperatures.

Apply heat with the flame directed AWAY from the center of the valve body. Excessive heat can harm the seats. After soldering, the packing nut may have to be tightened.



LFB6800

BAA/ARRA Compliant***

***This product complies with the Buy American Act and The American Recovery and Reinvestment Act. For more information, visit watts.com.

Specifications

Lead Free* 3-Piece, Full Port, Ball Valves shall be constructed using Lead Free* materials. Lead Free* valves shall comply with state codes and standards, where applicable, requiring reduced lead content. The valve must have a blowout proof stem, reinforced Durafill seats, reinforced PTFE stem packing, and stainless steel ball. Pressure rating no less than 600psi (41 bar) WOG non-shock, 150psi (10 bar) WSP for 1/4" – 1" and 400psi (28 bar) WOG non-shock, 125psi (8.6 bar) WSP for 1 1/4" – 2". Valve must conform to MSS-SP-110 and shall be a Watts Series LFB6800 (threaded) or LFB6801 (solder).

Options

- Suffix
- XH – Extended handle
- LL – Latch-Lok handle (304 SS)



Exclusive Latch-Lok Handle (option LL)

Pressure – Temperature

Temperature Range: 0°F – 450°F (-18°C – 232°C)

1/4" – 1"

- 600psi (41 bar) WOG non-shock
- 150psi (10 bar) WSP

1 1/4" – 2"

- 400psi (28 bar) WOG non-shock
- 125psi (8.6 bar) WSP

Watts product specifications in U.S. customary units and metric are approximate and are provided for reference only. For precise measurements, please contact Watts Technical Service. Watts reserves the right to change or modify product design, construction, specifications, or materials without prior notice and without incurring any obligation to make such changes and modifications on Watts products previously or subsequently sold.

WATTS®

Materials

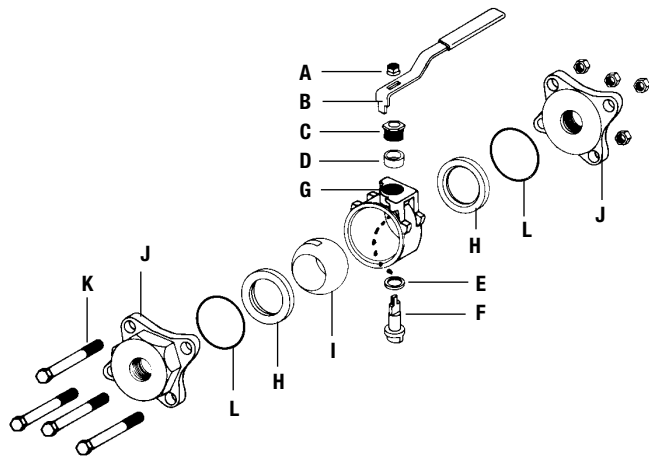

- A Handle Nut Zinc plated carbon steel
- B Handle Zinc plated carbon steel with vinyl insulator
- C Packing Nut Brass ASTM B16, C36000
- D Stem Packing Glass reinforced PTFE
- E Thrust Bearing Glass reinforced PTFE
- F Stem 316 Stainless steel
- G Body Lead Free* Brass
- H Seats Carbon/Glass reinforced PTFE Durafill®
- I Ball 316 Stainless steel
- J Adapter Lead Free* Brass
- K Body Bolts & Nuts Zinc plated carbon steel
- L Body Seals PTFE

Dimensions – Weights

LFB6800

SIZE	C				H				I				L				WEIGHT	
	in.	in.	mm	mm	in.	mm	in.	mm	in.	mm	in.	mm	in.	mm	Lbs.	Kg.		
1/4	1 3/4	44	3 7/8	98	3/8	10	2 3/8	60	1.1	.5								
3/8	1 3/4	44	3 7/8	98	3/8	10	2 3/8	60	1.1	.5								
1/2	1 3/4	44	3 7/8	98	1/2	13	2 3/8	60	1.1	.5								
3/4	2 1/4	57	4 1/2	114	3/4	19	3 1/4	83	2.5	1.1								
1	2 3/4	70	6 1/8	156	1	25	3 7/8	98	4.1	1.9								
1 1/4	3	76	6 1/8	156	1 1/4	32	4 1/2	114	6.3	2.9								
1 1/2	3 1/2	89	8	203	1 1/2	38	5	127	9.3	4.2								
2	3 7/8	98	8	203	2	51	6 5/8	168	13.8	6.3								

LFB6801**

1/2	1 3/4	44	3 7/8	98	1/2	13	2 3/8	60	1.1	.5
3/4	2 1/4	57	4 1/2	114	3/4	19	3 1/4	83	2.5	1.1
1	2 3/4	70	6 1/8	156	1	25	3 7/8	98	4.1	1.9
1 1/4	3	76	6 1/8	156	1 1/4	32	4 1/2	114	6.3	2.9
1 1/2	3 1/2	89	8	203	1 1/2	38	5	127	9.3	4.2
2	3 7/8	98	8	203	2	51	6 5/8	168	13.8	6.3

**See solder instructions on front.

Valve Seat Rating

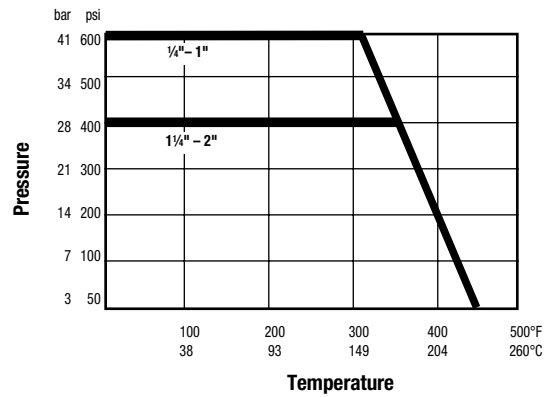

Pressure Drop vs. Flow

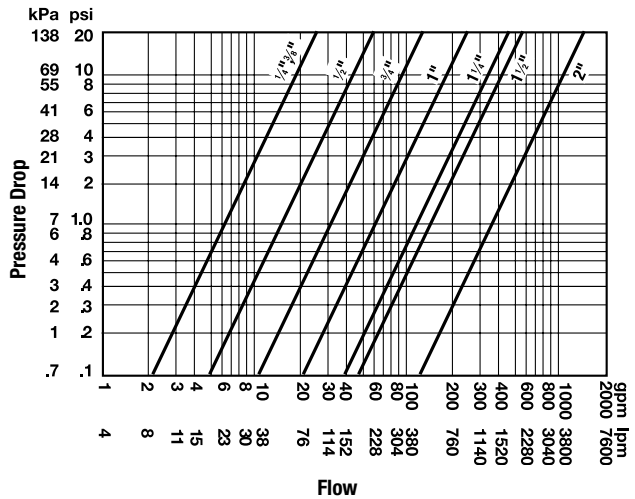

SIZE	TORQUE		
in.	in.-lbs.	n-m	Cv
1/4-3/8	60	6.8	6
1/2	60	6.8	15
3/4	150	16.9	30
1	200	22.6	60
1 1/4	250	28.2	110
1 1/2	320	36.2	130
2	500	56.5	360

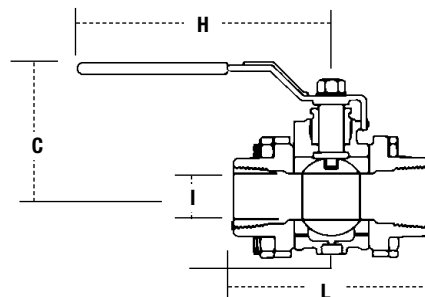

A Watts Water Technologies Company

USA: Tel: (978) 689-6066 • Fax: (978) 975-8350 • Watts.com

Canada: Tel: (905) 332-4090 • Fax: (905) 332-7068 • Watts.com

Latin America: Tel: (52) 81-1001-8600 • Fax: (52) 81-8000-7091 • Watts.com